

THIS DRAWING IS THE SOLE PROPERTY OF OEM CONTROLS INC., 10 CONTROLS DRIVE, SHELTON, CT 06484, USA. THIS DOCUMENT CONTAINS OEM PROPRIETARY INFORMATION. WRITTEN PERMISSION TO USE OR DISCLOSE ANY INFORMATION HEREIN MUST BE OBTAINED FROM OEM.

REVISIONS

REV	DESCRIPTION	DATE	APPROVED
A	ORIGINAL	AJS 7/21/99	

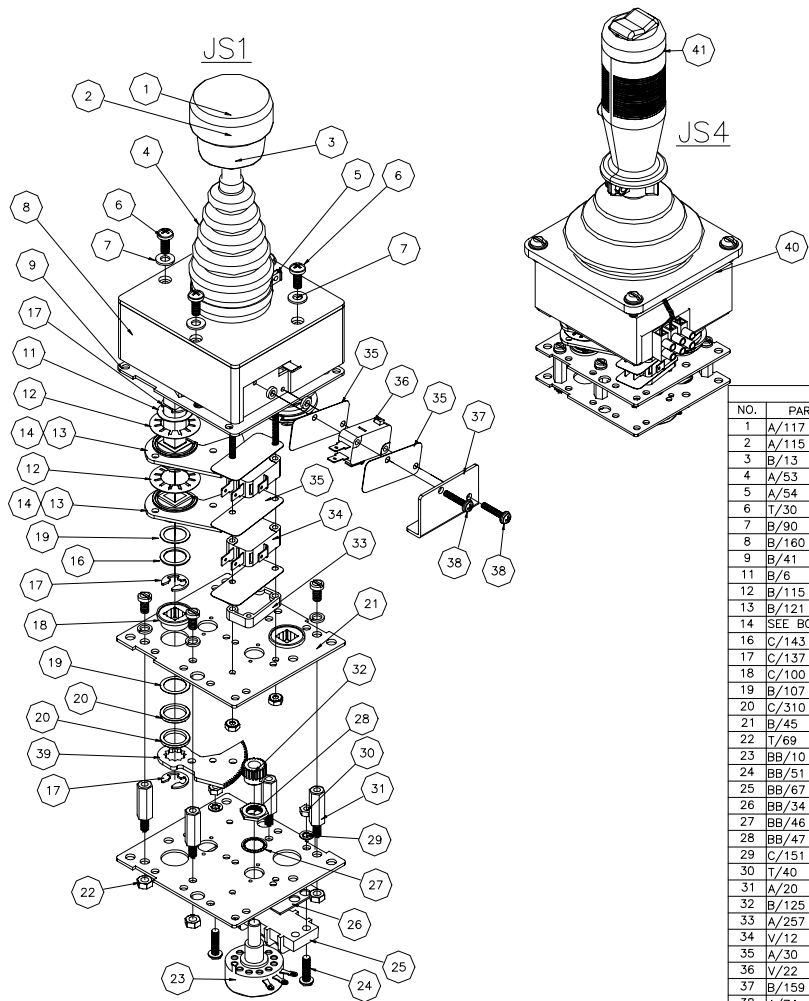

Parts List			
NO.	PART#	DESCRIPTION	QTY
1	A/117	SPRING	1
2	A/115	HANDLE	1
3	B/13	HANDLE	1
4	A/53	BOOT	1
5	A/54	CLAMP	1
6	T/30	SCREW	4
7	B/90	WASHER	4
8	B/160	HOUSING	1
9	B/41	PLATE	1
11	B/6	WASHER	2
12	B/115	WASHER (LOCK)	4
13	B/121	COUPLING	4
14	SEE BOM	CAM SEE BOM	4
16	C/143	WASHER BUSHING	2
17	C/137	"E" CLIP	5
18	C/100	BEARING	4
19	B/107	WASHER	3
20	C/310	SPACER	2
21	B/45	PLATE	2
22	T/69	NUT	4
23	BB/10	POT	1
24	BB/51	SCREW	2
25	BB/67	TERMINAL STRIP	1
26	BB/34	MARKER STRIP	1
27	BB/46	WASHER (POT)	1
28	BB/47	NUT (POT)	1
29	C/151	WASHER	2
30	T/40	NUT	2
31	A/20	STANDOFF	4
32	B/125	GEAR	1
33	A/257	INSULATOR	1
34	V/12	MICROSWITCH	2
35	A/30	INSULATOR	5
36	V/22	MICROSWITCH	1
37	B/159	COVER	1
38	A/74	SCREW	2
39	B/82	GEAR	1
40	B/133	JS4 CASTING	1
41	SEE BOM	HANDLE FOR JS4	1

DRAWN BY	AJS	DATE	7/21/99
CHECKED			
APVD ENG.			
APVD DESN			
APVD SALES			



10 Controls Drive - Shelton, CT 06484
 Phone: (203) 929-8431 Fax: (203) 929-7546

SPARE PARTS FOR JS4 & JS1

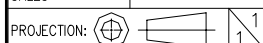

PART NO.	DWG NO. A6536	REV. A
SCALE N/A	SHEET 1 of 1	SIZE A